

**SILICON
CHIP**

IR Remote Control Receiver

⊕
Ack

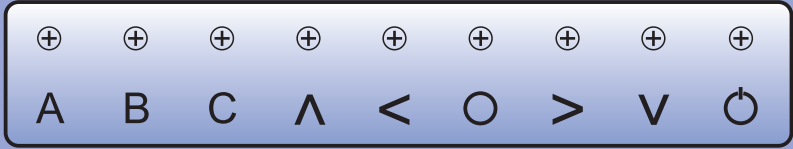

Outputs

12V DC ⊕+

On-board relays: 24V max. @ 500mA

**SILICON
CHIP**

IR Remote Control Receiver

⊕
Ack

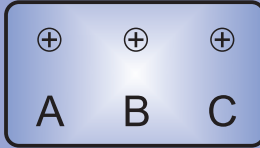

Device

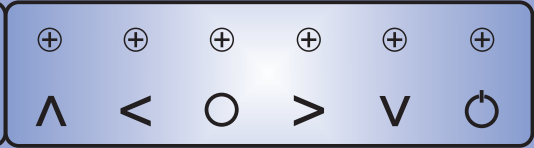

Outputs

12V DC ⊕+

On-board relays: 24V max. @ 500mA

Rear-panel drilling template

A = 12mm diameter
B = 11mm diameter

65mm

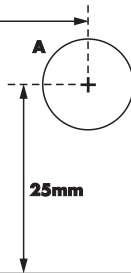

27mm

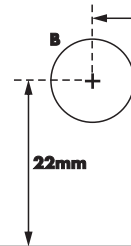

On-board relay
contacts: 24V,
500mA max.

Power
12V DC ⊕+

